

16 oz

TWO PIECE AL. CAN
202/211x603, 475ml
Product Specification

Document No:

Edition: A1

Revision Date: 2019-7-15

Page No: 1/2

TWO PIECE AL CAN 202/211x603, 475ml FOR CARBONATED SOFT DRINK/HOT FILL WITH LIQUID NITROGEN/BEER

SCOPE :

THIS STANDARD IS APPLIED TO TWO PIECE AL. CAN BODY 202/211x603
IT COVERS THE CAN MATERIAL SPECIFICATION AND THE FACTORY FINISHED
CAN DIMENSIONAL STANDARD.

PLATE MATERIAL :

-ALUMINUM.
-TYPE AND TEMPET: 3104.H19.

STRENGTH :

-AXIAL LOAD : ≥ 0.8 KN
-BUCKLE : ≥ 610 KPA

COATINGS :

-INSIDE : MODIFIED EPOXY
-OUTSIDE : DECORATED + CLEAR VARNISH + BRC

ENAMEL RATE :

-INTERNAL COATING COVERAGE : BEER ≤ 75 MA, AVERAGE ≤ 35 MA
SOFT DRINK ≤ 25 MA, AVERAGE ≤ 5 MA

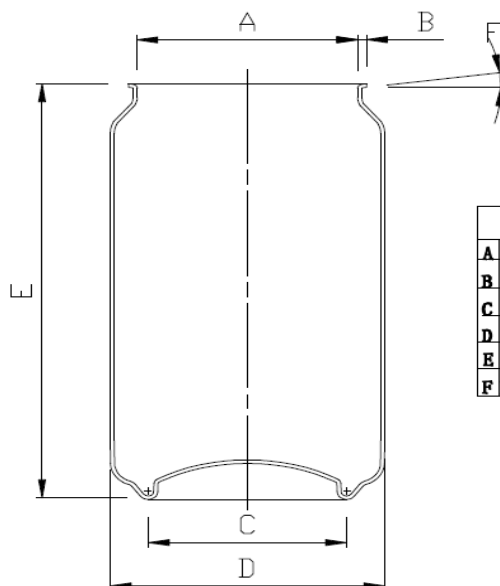

DIMENSION KEY	
A PLUG DIAMETER	52.40±0.25mm
B FLANGE WIDTH	2.11±0.25mm
C BASE DIAMETER	48.00mm REF.
D BODY OUTSIDE DIAMETER	66.04mm REF
E FINISHED CAN HEIGHT	157.23±0.38mm
F FLANGE ANGLE	0° -12°

16 oz

TWO PIECE AL. CAN
202/211x603, 475ml
Product Specification

Document No:

Edition: A1

Revision Date: 2019-7-15

Page No: 2/2

PACKING SPECIFICATION :

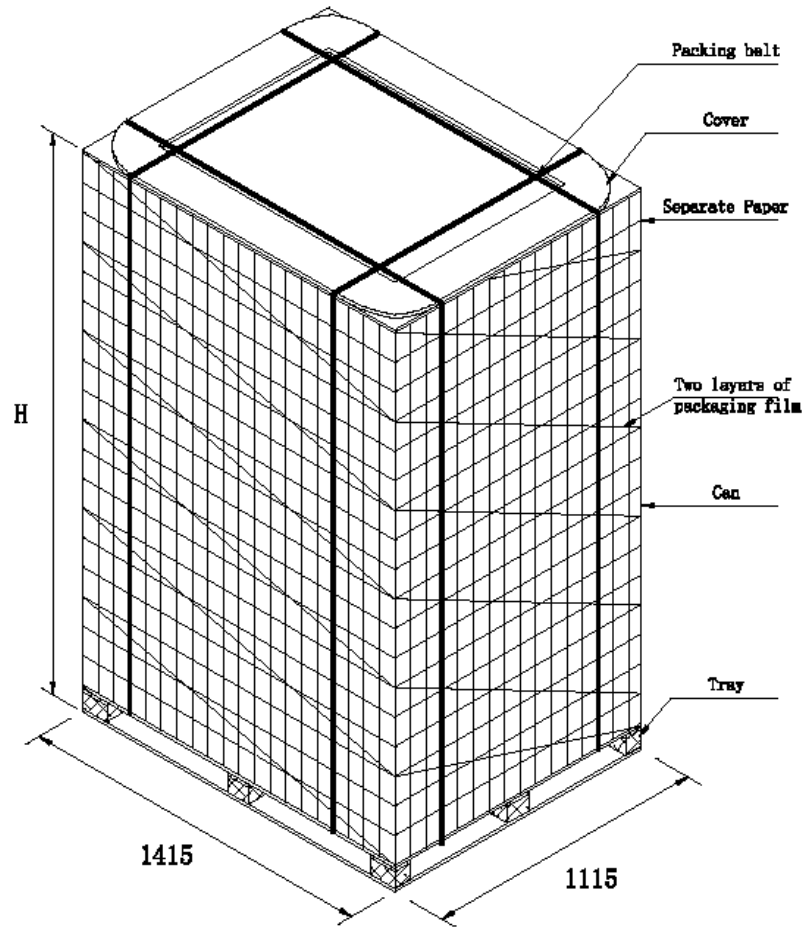

Package type	Package height	QTY/Per Tray (pcs)	QTY/Per Layer
13	2168 ± 15	5057	389
14	2328 ± 15	5446	
15	2488 ± 15	5835	
Prepared by:		Checked by:	Approved by: